

⚠ WARNING

1. A licensed professional must install and inspect the appliance. A licensed professional is a person who is licensed for the following (Connecting gas lines, water lines, valves, electricity)
2. Be sure to check for gas leakage before and after operating the product.
3. Refer to the manual for manifold pressure by model.

STEP ①

Disconnect the electrical power. Turn off the manual gas shut off valve and the water supply

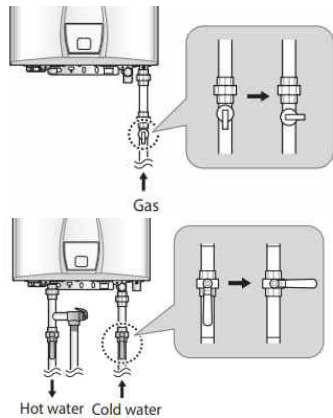

STEP ②

After opening the case,
Turning the Gas pipe ① nut loose counterclockwise and
Loosen the ② nut completely.



STEP ③

Assemble the orifice and angular ring shown in the figure.

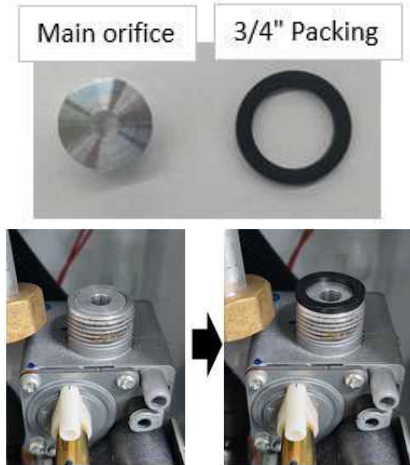

STEP ④

Tighten the ①, ② nut to connect the gas pipe.

※ Be careful not to assemble the packing incorrectly.



STEP ⑤

Remove the rubber packing No. 1 packing in the silencer part combined with the fan as shown in the figure.

※ Be sure to remove the packing at position.

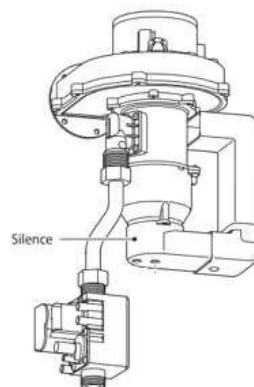

STEP ⑥

[If you have a combustion analyzer]

Turn on the gas and water supply

Set the Dip switch to minimum heat capacity operation. (Be sure to turn off the power before changing the DIP switch setting)

Insert analyzer into the exhaust analyzer hole and measure the gas/air ratio

The gas valve set screw will need to be adjusted. if adjustment is necessary, locate the set screw. Using a 5/32" or 4mm Allen wrench, turn the set screw no more than 1/4 turn clockwise to raise or counterclockwise to lower the CO₂ Value.

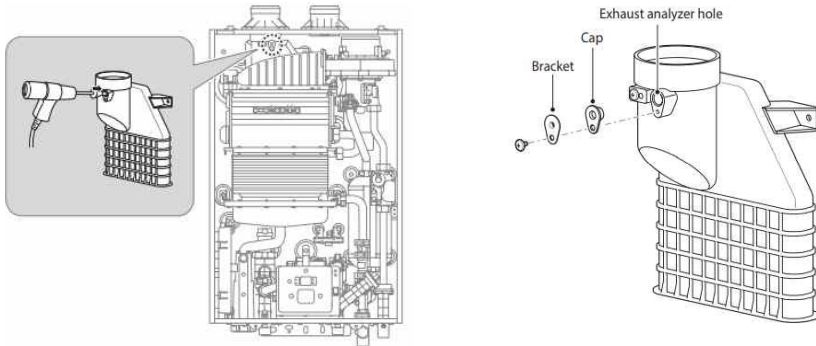

| Type | High fire | Low fire |
|------|---------------------|---------------------|
| | CO ₂ (%) | CO ₂ (%) |
| NG | 9.5 ± 0.5 | 9.9 ± 0.5 |
| LPG | 9.5 ± 0.5 | 11.5 ± 0.5 |

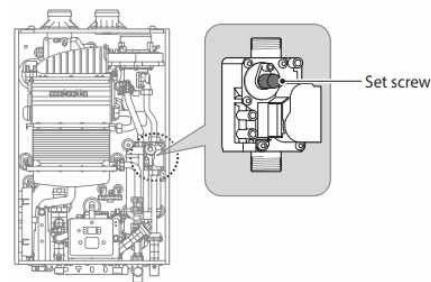

STEP ⑦

[If you do not have a combustion analyzer]

After removing the gas control cap, adjust the adjustment screw 45° counterclockwise as shown in the figure. After adjustment, reassemble the gas control cap.



STEP ⑧

When the gas conversion is completed, attach the conversion sticker to the top of the rating plate.

This appliance was converted on _____ / _____ / to _____ gas
with Kit No. _____
by _____
(name and address of organization making this conversion, who accepts the responsibility for the correctness of this conversion).

This appliance has been converted to Propane fuel /
Cet appareil a été converti au propane
Orifice Size / injecteur
Min. 3.9mm to Max. 3.1mm
Inlet Gas Pressure / Pression d'entree du gaz
Min. 8.0 to Max. 13.0" WC
Manifold Pressure /
Pression à la tubulure d'alimentation
Min. 0.01 to Max. -0.30(150), -0.56(199)" WC
Input (Btu/hr) / Débit calorifique
Min. 19,900 to Max. 150,000(150), 199,000(199)
Conversion Kit No. 421 10399